



川磊电子科技  
ThreeLayer Technologies, Inc.  
專業電感製造商

南充新川电子科技有限公司

ThreeLayer Scientific-Technics Co.,Ltd



产品承认书

SPECIFICATION FOR APPROVAL

客户名称 <i>CUSTOMER NAME.</i>	-----
产品类型 <i>PRODUCT TYPE</i>	Shielded Power Inductors
客户料号 <i>CUSTOMER P/N</i>	-----
川磊料号 <i>OURS P/N</i>	CDRI-6045AL- SERIES
文件编号 <i>FILE NO.</i>	SP-21072113

客户承认/ <i>CUSTOMER ACCEPTED</i>		
承认 <i>APPROVED</i>	确认 <i>CHECKED</i>	承办 <i>DESIGN</i>
批注/ <i>REMARK</i>		

批准 <i>APPROVED</i>	确认 <i>CHECKED</i>	作成 <i>DESIGN</i>
程志华	董兰瑶	蔡娟

生产工厂：南充川磊电子科技有限公司  
销售公司：南充新川电子科技有限公司  
业务专线：0817-2111163/18681773184  
邮 件：threelayer\_sales@163.com  
地 址：四川省南充市顺庆区潞华工业园区华生东路





客户名称 CUSTOER	-----	客户品名 CUSTOMER P/N	-----	版别 REV.	1.0
产品类型 PRODUCT TYPE	Shielded Power Inductors	新川品名 OURS P/N	CDRI-6045AL-SERIES	文件编号 FILE NO.	SP-21072113

一.尺寸图/DIENSION (单位/UNIT : )

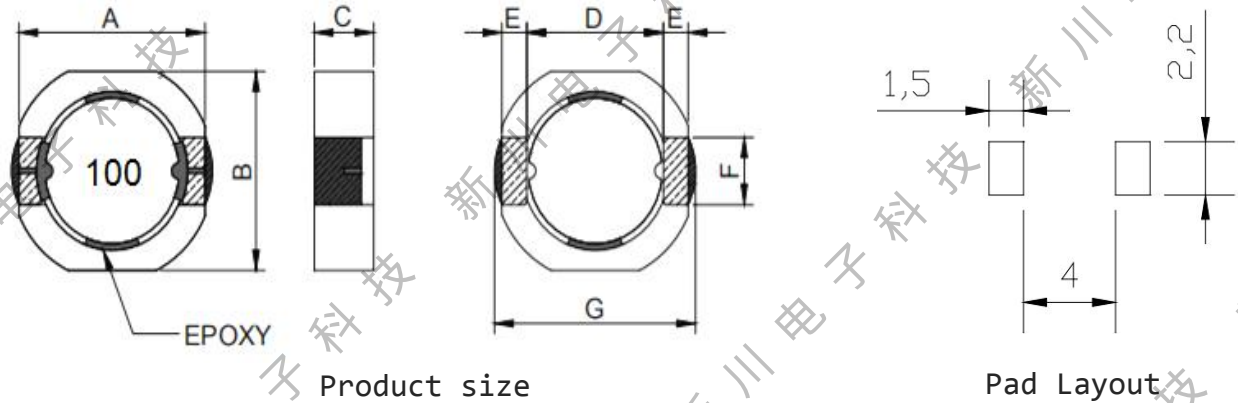

ITEM	A	B	C	D	E	F	G		
DIM	6.2	6.0	4.5	4.6	0.8	2.0	7.2		
TOLE	±0.3	±0.2	±0.3	Typ	Typ	Typ	Max		

二.电路图/CIRCUIT DIAGRA

三.注意事项/NOTE :

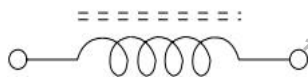

1.印字：白色

四.电气特性/ELECTRICAL CHARACTERISTIC

Part Number	Inductance (uH)	Tolerance	Test Frequency (Hz)	DCR (mΩ) ±30%	IDC1 (A) Max.	IDC2 (A) Max.	MARK
CDRI-6045AL-1R0□	1.0	N	100K/0.1V	11	6.7	4.8	1R0
CDRI-6045AL-1R5□	1.5	N	100K/0.1V	13	5.5	4.5	1R5
CDRI-6045AL-2R2□	2.2	N	100K/0.1V	15	4.2	4.1	2R2
CDRI-6045AL-3R3□	3.3	N	100K/0.1V	19	3.5	3.7	3R3
CDRI-6045AL-4R7□	4.7	N	100K/0.1V	23	3.1	3.3	4R7
CDRI-6045AL-6R8□	6.8	N	100K/0.1V	27	2.5	3.1	6R8
CDRI-6045AL-100□	10	M, N	100K/0.1V	35	2.1	2.6	100
CDRI-6045AL-150□	15	M, N	100K/0.1V	60	1.7	3	150
CDRI-6045AL-220□	22	M, N	100K/0.1V	75	1.4	1.8	220
CDRI-6045AL-330□	33	M, N	100K/0.1V	100	1.1	1.6	330
CDRI-6045AL-470□	47	M, N	100K/0.1V	130	0.97	1.4	470
CDRI-6045AL-680□	68	M, N	100K/0.1V	200	0.81	1.1	680

承认书/SPECIFICATION FOR APPROVAL

客户名称 CUSTOMER	-----	客户品名 CUSTOMER P/N	-----	版别 REV.	1.0
产品类型 PRODUCT TYPE	Shielded Power Inductors	新川品名 OURS P/N	CDRI-6045AL- SERIES	文件编号 FILE NO.	SP-21072113

四.电气特性/ELECTRICAL CHARACTERISTIC

Part Number	Inductance (uH)	Tolerance	Test Frequency (Hz)	DCR (mΩ) ±30%	IDC1 (A) Max.	IDC2 (A) Max.	MARK
CDRI-6045AL-101□	100	M, N	100K/0.1V	320	0.61	0.86	101
CDRI-6045AL-331□	330	M, N	100K/0.1V	1500	0.47	0.45	331
CDRI-6045AL-471□	470	M, N	100K/0.1V	1680	0.27	0.27	471
CDRI-6045AL-222□	2200	M, N	100K/0.1V	1750	0.08	0.1	222

- (1).Specify the inductance tolerance, K(±10%), L(±15%), M(±20%),N(±30%)
  - (2).IDC1:Base on temp.rise &  $\Delta L/L0A \leq 35\% \text{ MAX}$
  - (3).IDC2:Temp.rise 45°C Typ
  - (4).Operating temp.: -40°C to +125°C
  - (5).Storage Temp: -20°C up to +40°C, 75% RH max.
- ※:Rated DC Current : The less value which is IDC1 or IDC2

五.材料清单/MATERIAL LIST

NO.	ITEM	DESCRIPTION
1	CORE	FERRITE
2	BASE	C1100H
3	WIRE	P180 Grd1
4	SOLDER	107H
5	ADHESIVE	G500HF+FW5013
6	INK	WHITE

承认书/SPECIFICATION FOR APPROVAL

客户名称 CUSTOMER	-----	客户品名 CUSTOMER P/N	-----	版别 REV.	1.0
产品类型 PRODUCT TYPE	Shielded Power Inductors	新川品名 OURS P/N	CDRI-6045AL- SERIES	文件编号 FILE NO.	SP-21072113

六.可靠性测试/RELIABILITY TESTING

Operating Temperature	- 40 to +125 °C ( Contain Heating coil )
Appearance Inspection	No external defects by visual inspection
Terminal Strength	After soldering , between copper plaet and terminals of coils , push in two directions of X , Y with standing 10N(1.02kg) for10+/-2 sec. Terminal should not peel off. ( Refer to figure at right )
Heat endurance of reflow soldering	Refer to figure
Insulating resistance	Over 100 MΩ at 100V D.C . between wire and core
Dielectric Strength	Apply at 0.5KV 3mA for 1 minute between wire and core
Temperature characteristics	Inductance coefficient ( 0~2,000 ) × 10 / °C ( - 40~ + 125 °C )
Humidity characteristics	Inductance deviation within ± 10% , after 96 hours in 90~95% relative humidity at 40 ± 2 °C and 1 hours drying under normal condition

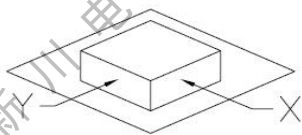

A test is made under the above mentioned condition , and it is kept for 2 hours in the normal

IR Reflow profile

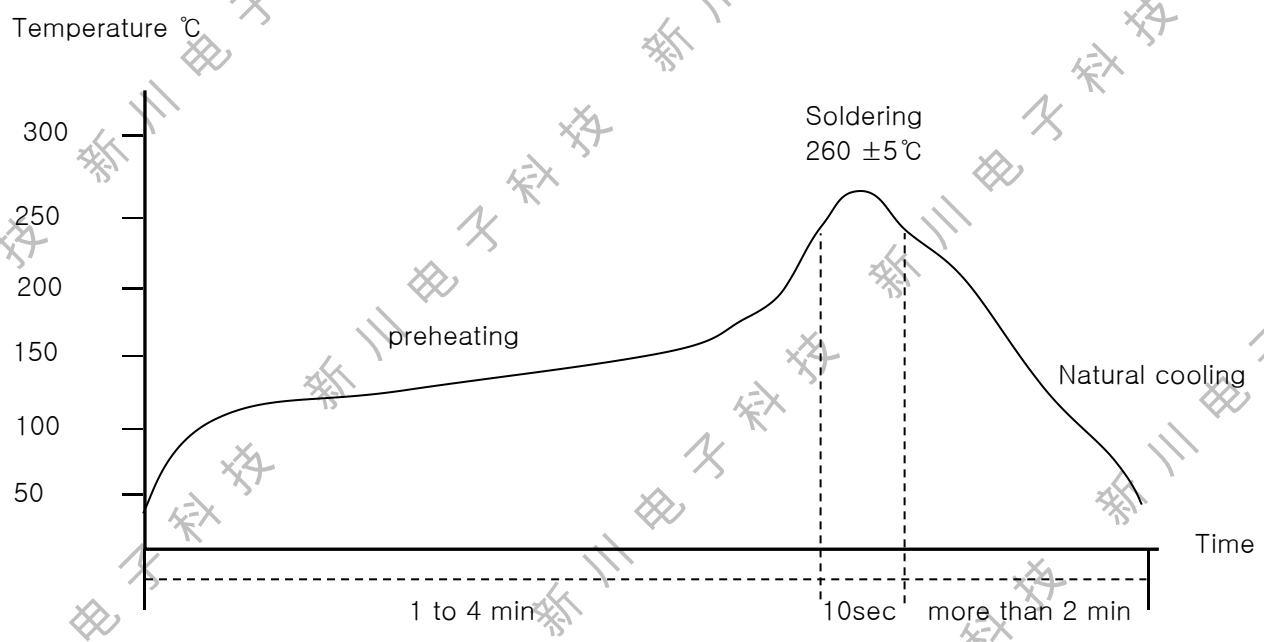

Temperature and humidity . After that , no mechanical and electrical defect should be found .

客户名称 CUSTOMER	-----	客户品名 CUSTOMER P/N	-----	版别 REV.	1.0
产品类型 PRODUCT TYPE	Shielded Power Inductors	新川品名 OURS P/N	CDRI-6045AL- SERIES	文件编号 FILE NO.	SP-21072113

七.编带规格/TAPING SPECIFICATIONS

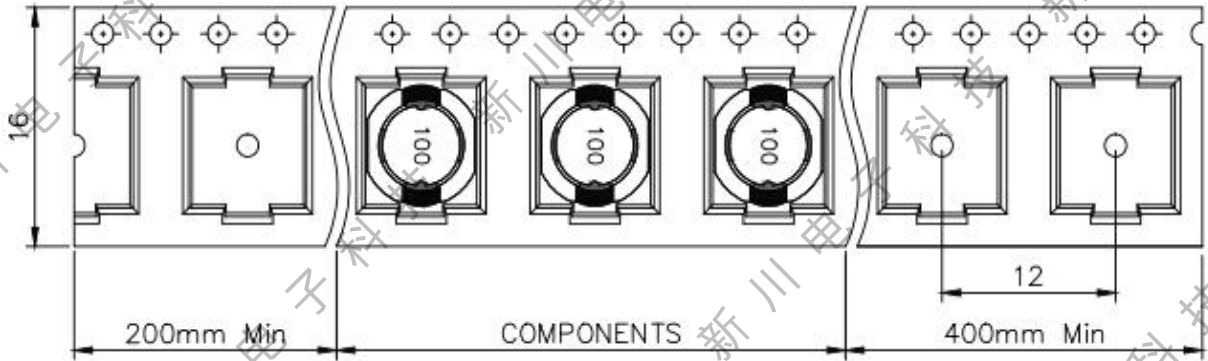

Transparent carrier and cover tape/透明载带和自粘上带

Adhesive strength of cover tape is 20 to 120 gf

The conduction band direction

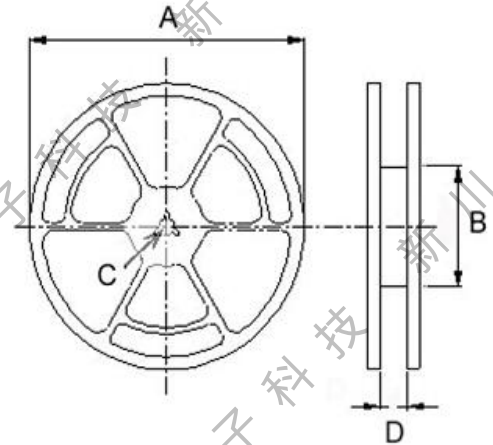
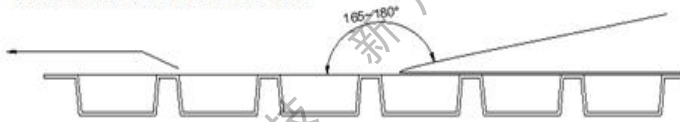

Reel Dimensions (Unit: mm)				Quantity
A	B	C	D	Pcs/Reel
330	100	13	16.5	1000

八.包装方式/PACKING LIST

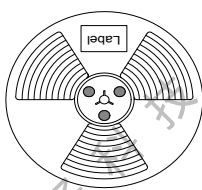

轮盘：13(直径330mm)  
数量：1000PCS/盘

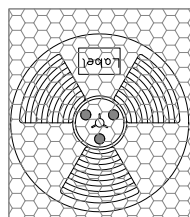

PE袋  
数量：1000PCS/袋

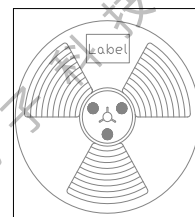

内盒  
数量：3000PCS/盒



外箱，数量：15000PCS/  
箱  
不足整箱用内盒或填充